

Supreme Air Venturi Fume Hood

V05F 28...

General Purpose Bench Hood with Vertical Rising Sash

(indicate fittings/fixtures required)
(hole plugged if no fitting specified)

(indicate fittings/fixtures required)
(hole plugged if no fitting specified)

[Option K - Fan/Blower Switch]

Light/Sash Stop Controller

[Water]

[Option P1 - Cord Port]

120VAC GFCI Double Duplex

[Option A1/A3 Alarm]

[Water]

[Option P1 - Cord Port]

120VAC GFCI Double Duplex

Pre-piping: (pick one if required)

- IN** Installed (no piping)
- PU** Pre-piped Up
- PD** Pre-piped Down
- SP** Pre-piped Single Point
 - Up - Left Side
 - Up - Right Side

Receptacles: (pick one)

- S** Spec. Grade GFCI
- H** Hospital Grade GFCI

Receptacle Color: (pick one)

- K** Black
- W** White
- R** Red
- V** Ivory
- G** Grey

Wiring: (pick if required)

- U** Pre-wired - Top of Hood

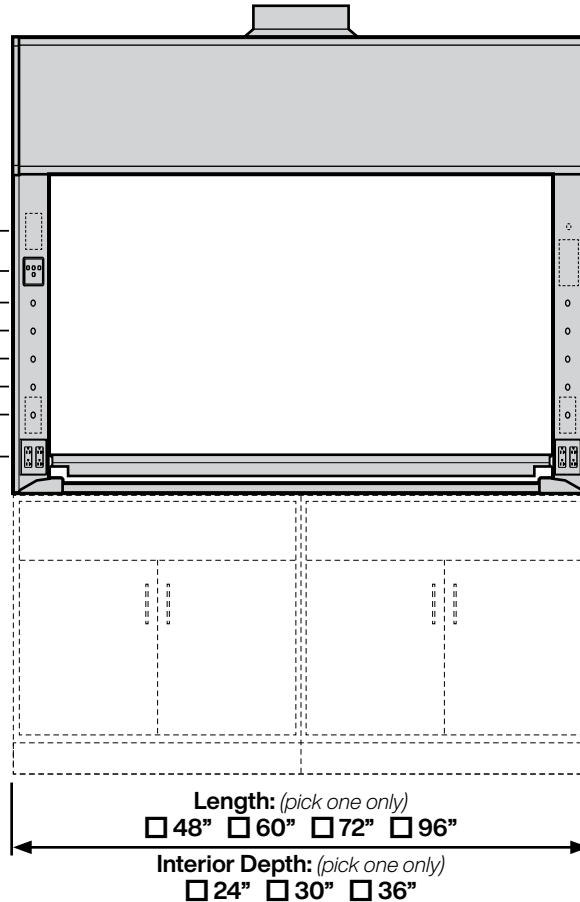

Required Options: (pick from each group)

- Interior Liner Material** (pick one)
- G** Kemglass (Fiberglass Reinforced Polyester)
 - L** Type 316L Stainless Steel
 - S** Type 304L Stainless Steel
 - T** Phenolic Resin

Sash Frame (pick one)

- N** Frameless
- M** Powder Coated Steel Frame
- S** Type 304L Stainless Steel Frame

Sash Glass (pick one)

- G1** Laminated Safety Glass
- G2** Tempered Safety Glass
- G3** Polycarbonate

Service Fitting Valve Type (pick one)

- F1** Rod Control Needle Valves
- F3** Front Load Needle Valves

- V** Modified By-pass for VAV Control System

VAV Controller Manf:

Model:

Minimum CFM:

Add-on Options: (pick all required)

- A1** Air Alert 600 Alarm
- A3** Air Alert 300 Alarm
- L** Sash Stop Label

- D** Distillation Rack - Preparation
- E** Fire Suppression System
- S** Safety Shield
- T** Tissue Screen
- P1** Cord Ports - one in each post

- B1** Vapor Proof Light
- B2** Explosion Proof Light
- K** Fan/Blower Switch - (1 hp motor rated)

- O** Stainless Steel Airfoil - Type 304L
- O2** Stainless Steel Airfoil - Type 316L
- Q** Stainless Steel Sash Pulls
- C** Stainless Steel Duct Collar

- R1** Auto Sash Return
- R3** Proximity Sash Operator

| Sash Height | Inside Depth | Overall Length | Hood Liner | Sash Frame | Sash Glass | Service Fittings | Electrical Fixtures | Add-on Options (separated by commas) | COLOR | ITEM NO. | QUANTITY |
|-------------|--------------|----------------|------------|------------|------------|------------------|---------------------|--------------------------------------|-------|----------|----------|
| V05F28 | | | | | | | | | | | |

Technical Information

V05F 28...

Airflow (CFM) Requirements

| Face Velocity | 28" High Sash Opening | | | | | | | | 18" High Sash Opening | | | | | | | |
|---------------|-----------------------|------|----------|------|----------|------|----------|------|-----------------------|------|----------|------|----------|------|----------|------|
| | 4' / 48" | | 5' / 60" | | 6' / 72" | | 8' / 96" | | 4' / 48" | | 5' / 60" | | 6' / 72" | | 8' / 96" | |
| | CFM | SP | CFM | SP | CFM | SP | CFM | SP | CFM | SP | CFM | SP | CFM | SP | CFM | SP |
| 100 FPM | 772 | 0.35 | 1010 | 0.44 | 1247 | 0.55 | 1722 | 0.38 | 502 | 0.15 | 656 | 0.19 | 810 | 0.24 | 1118 | 0.16 |
| 80 FPM | 618 | 0.23 | 808 | 0.29 | 998 | 0.36 | 1378 | 0.25 | 401 | 0.10 | 525 | 0.13 | 648 | 0.16 | 895 | 0.11 |
| 60 FPM | 464 | 0.13 | 606 | 0.16 | 749 | 0.21 | 1034 | 0.14 | 301 | 0.06 | 394 | 0.07 | 486 | 0.09 | 671 | 0.06 |
| 50 FPM | 386 | 0.09 | 506 | 0.12 | 624 | 0.15 | 861 | 0.10 | 251 | 0.04 | 328 | 0.05 | 405 | 0.07 | 559 | 0.04 |

Static pressures shown are for the pressure drop through the hoods only. The total pressure drop through the hood and the duct system must be calculated to select the proper exhaust fan.

ANSI Z9.5 Minimum Flow Rate Flow Rate

| Inside Depth | 150 Air Changes/Hour | | | | 375 Air Changes/Hour | | | |
|--------------|----------------------|----------|----------|----------|----------------------|----------|----------|----------|
| | 4' / 48" | 5' / 60" | 6' / 72" | 8' / 96" | 4' / 48" | 5' / 60" | 6' / 72" | 8' / 96" |
| 24" deep | 80 CFM | 100 CFM | 120 CFM | 170 CFM | 190 CFM | 240 CFM | 300 CFM | 410 CFM |
| 30" deep | 90 CFM | 120 CFM | 150 CFM | 200 CFM | 230 CFM | 290 CFM | 360 CFM | 500 CFM |
| 36" deep | 110 CFM | 140 CFM | 170 CFM | 240 CFM | 270 CFM | 350 CFM | 430 CFM | 590 CFM |

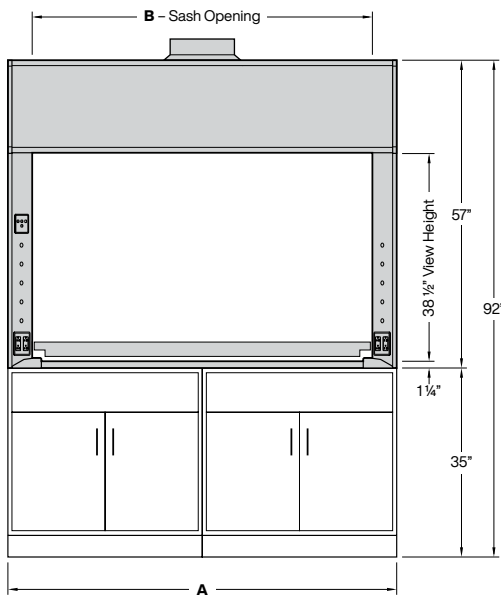
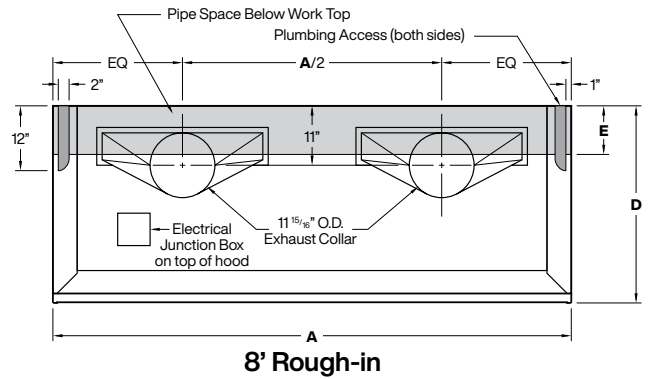
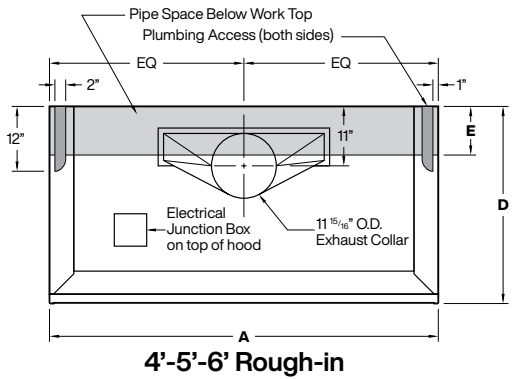

| Dimensions - Length | | | | |
|---------------------|-----|-----|-----|-----|
| A | 48" | 60" | 72" | 96" |
| B | 39" | 51" | 63" | 87" |

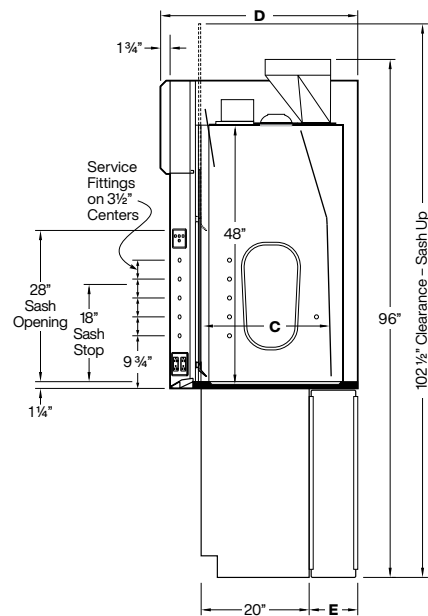

| Dimensions - Depth | | | |
|--------------------|---------|---------|---------|
| C | 24" | 30" | 36" |
| D | 36 1/2" | 42 1/2" | 48 1/2" |
| E | 9" | 15" | 21" |